

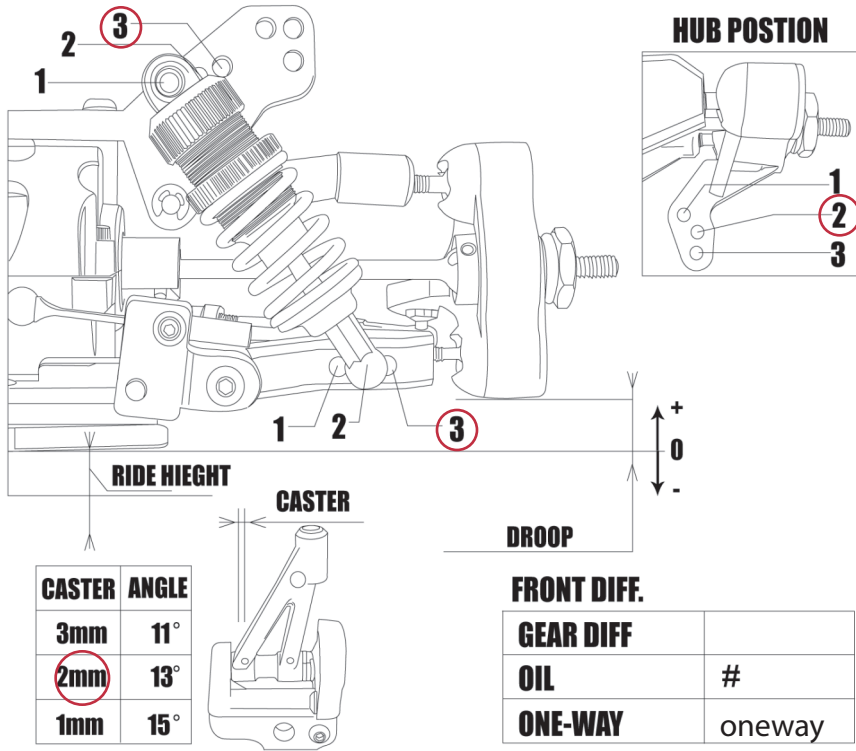

SETTING SHEET Ver1.00

NAME	Jeffrey Lin	TEMP		ENGINE	RB V12	MUFFLER	
DATE	7/22/05	HUMIDITY		HEAD CLEARANCE	mm	FUEL/TYPE	
TRACK	REV	TRACTION		PLUG NO.		RADIO	



TRACK WIDTH	199	mm
RIDE HIEGHT	4	mm
CAMBER ANGLE	L	3° 2.5' 2(1.5) 1°.05' 0°
	R	3° 2.5' 2(1.5) 1°.05' 0°
SUSPENSION BLOCKS	F	2.5° 1.5° 0°
	R	2.5° 1.5° 0°
CASTER ANGLE	3mm 2mm 1mm	
TOE ANGLE	out .5	°
DROOP		mm
SHOCKTOWER	1 2 3	
LOWER A-ARM	1 2 3	
PISTON	2 big holes	
OIL	# 70	
SPRING	yellow	
SHOCK LENGTH		mm
ANTIROLL BAR	⊖ ⊗ ⊘ ⊙ ⊕	
TIRE HARDNESS	32 35 37 40 42 45	
TIRE TYPE	Jaco	
TIRE DIAMETER	58	mm

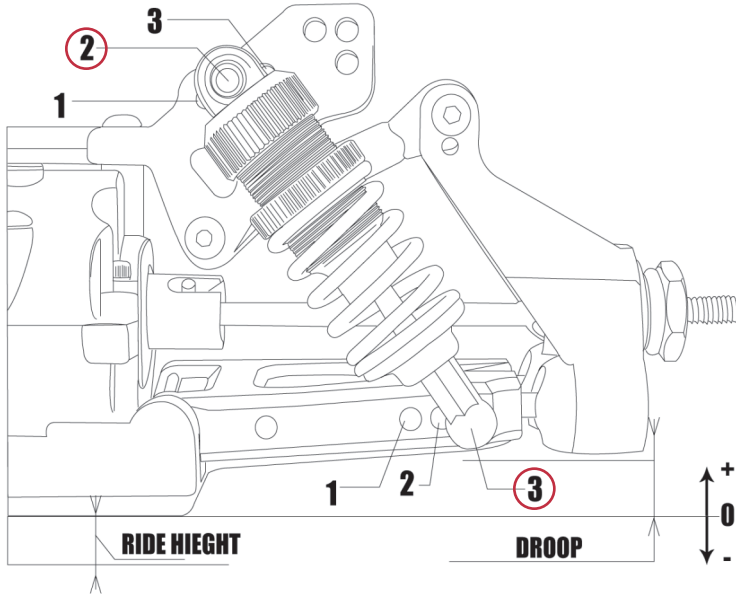

TRACK WIDTH	200	mm
RIDE HIEGHT	4.5	mm
CAMBER ANGLE	L	3° 2.5' 2° 1.5' 1°.05' 0°
	R	3° 2.5' 2° 1.5' 1°.05' 0°
SUSPENSION BLOCKS	F	2.5° 1.5° 0°
	R	2.5° 1.5° 0°
TOE ANGLE	in 2	°
DROOP		mm
SHOCKTOWER	1 2 3	
LOWER A-ARM	1 2 3	
PISTON	2 big holes	
OIL	# 50	
SPRING	Red	
SHOCK LENGTH		mm
WIRE TYPE		mm
ANTIROLL BAR	⊖ ⊗ ⊘ ⊙ ⊕	
BLADE TYPE	⊖ ⊗ ⊘ ⊙ ⊕	
TIRE HARDNESS	32 35 37 40 42 45	
TIRE TYPE	Jaco	
TIRE DIAMETER	59	mm
TIRE WIDTH	30	mm

CLUTCH TYPE		PINIONS	16 17 18 19 / 20 21 22 23 24
CLUTCH SHOES		GEARS	37 38 39 40 41 42 43 44
CLUTCH SPRING		BODY	
CLEARANCE	mm	RACE TIME	
ADJ. NUT	mm	BEST LAP	

COMMENTS: 21 / 27 54 / 48 new .8 power clutch

REAR DIFF.	
GEAR DIFF	
OIL	# 100000