

INSTRUCTIONS #35001 1/8 SCALE 2-SPEED TRANSMISSION SET (Cam Type)

* This two speed transmission is only for "ULTRA"s " 1/8 Scale Car Kits. (All Models)

1 2-SPEED ASSEMBLY

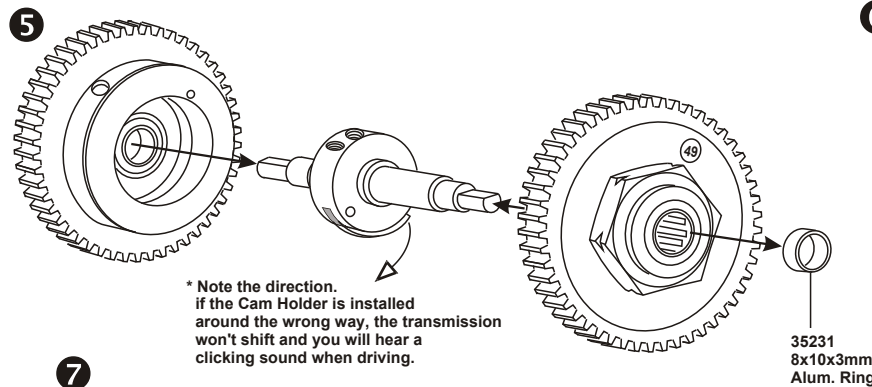
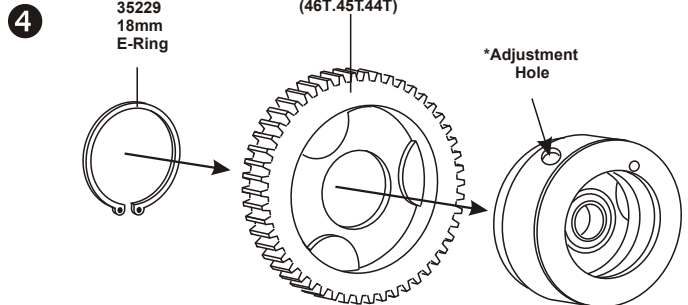
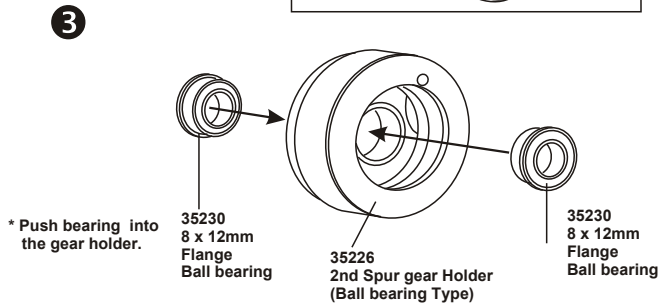
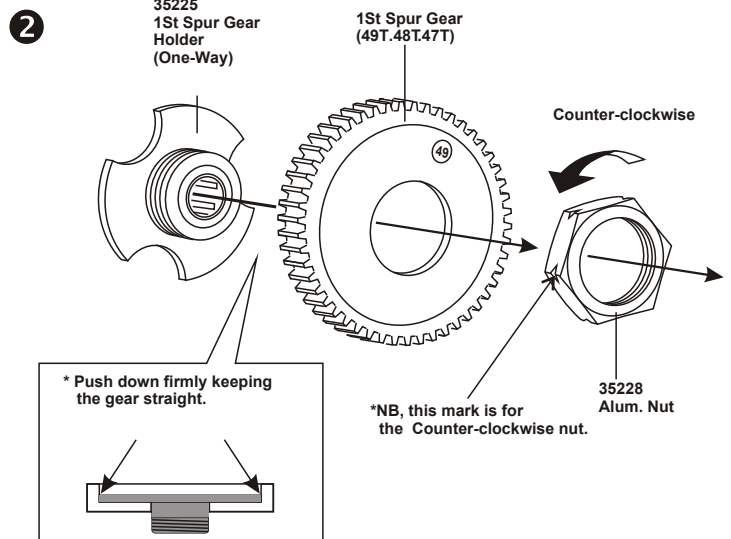
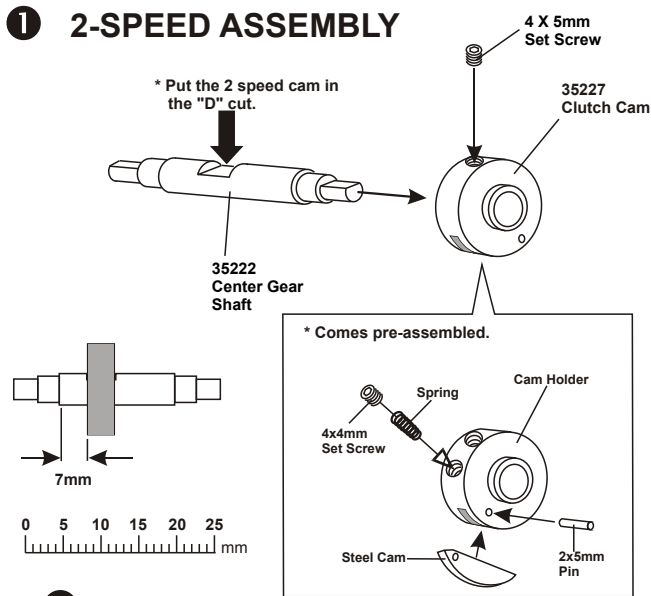

6 2 SPEED TRANSMISSION AFTER ASSEMBLY.

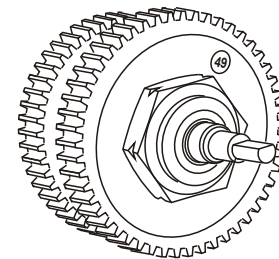

7 (Use the parts that come with your kit.)

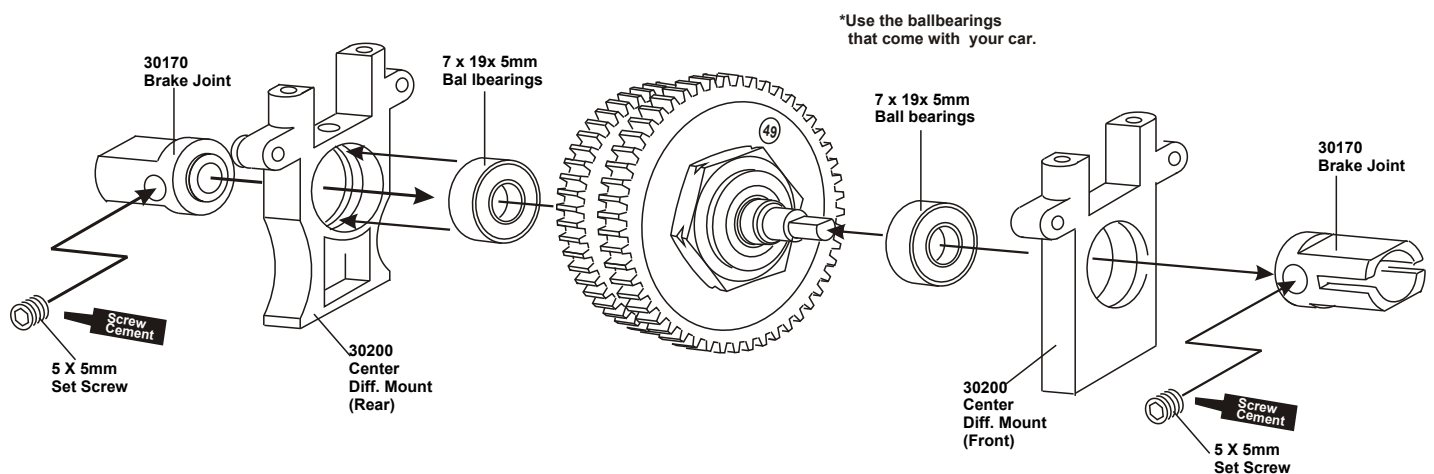

8 (Use the parts that come with your kit.)

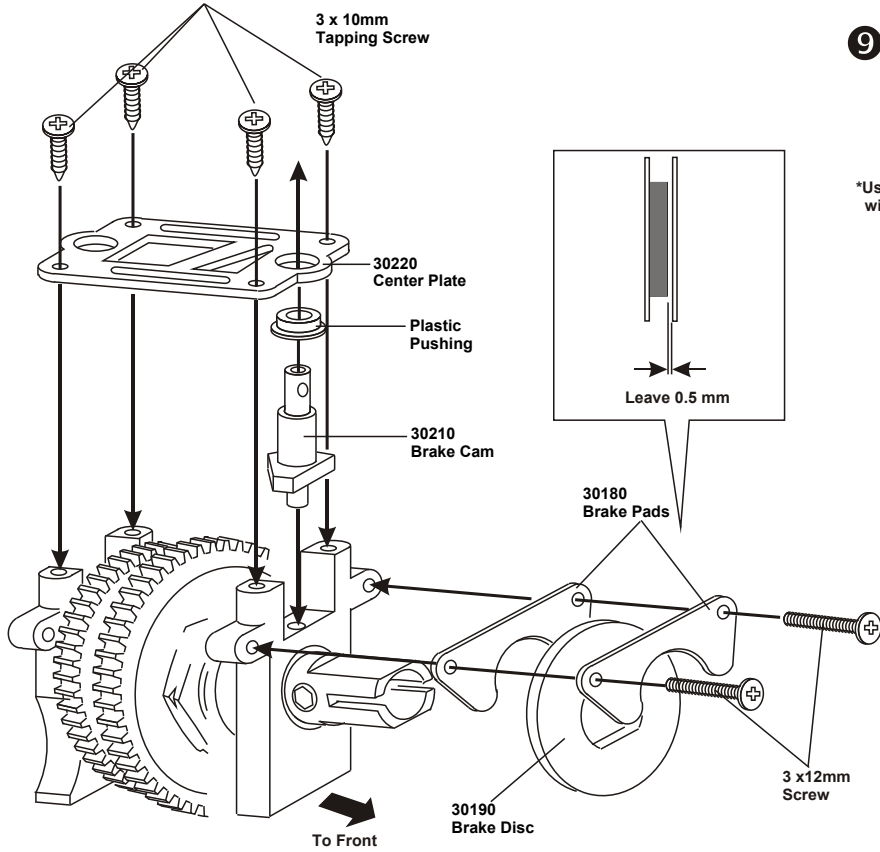

9

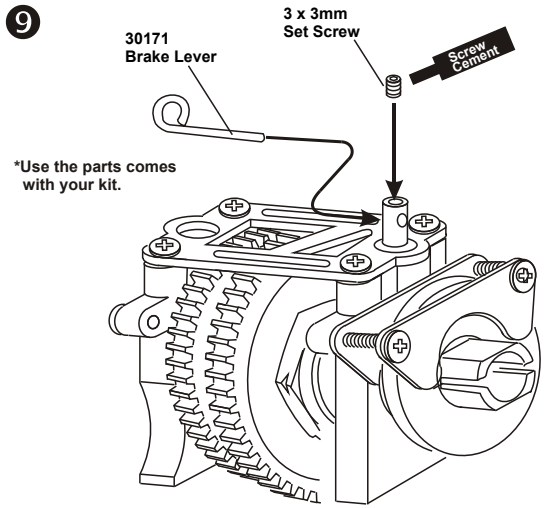

ASSEMBLY OF THE 2 SPEED CLUTCH BELL

(FOR NORMAL PILOT SHAFT)

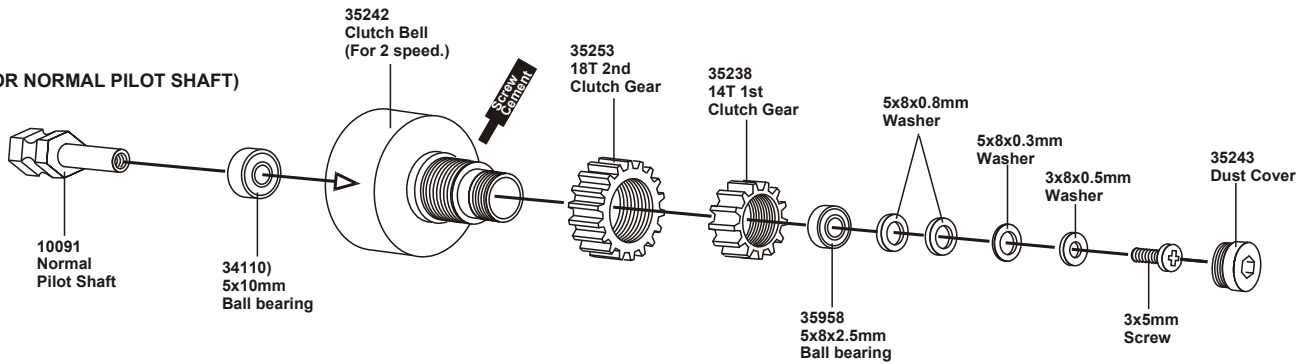

(FOR SG PILOT SHAFT)

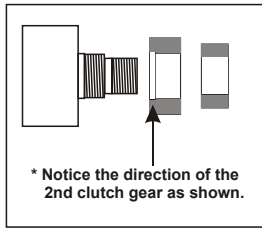
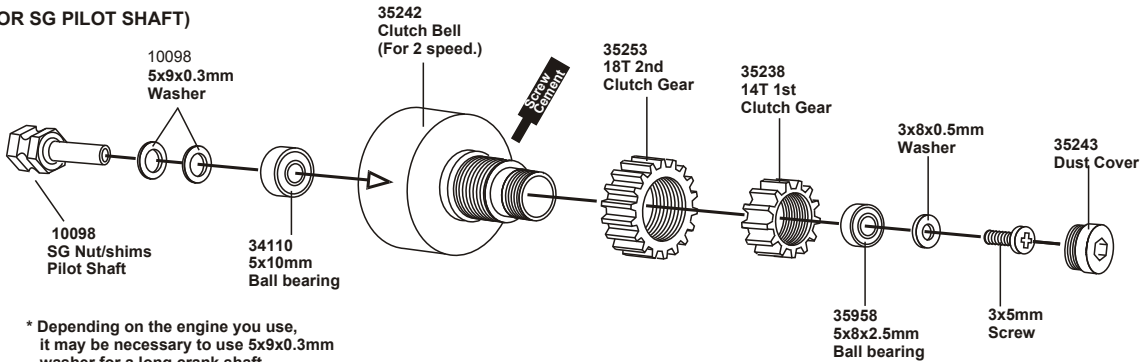

* Depending on the engine you use, it may be necessary to use 5x9x0.3mm washer for a long crank shaft.

ADJUSTING THE SHIFT POINT

* Adjust the engine before adjusting the clutch shift timing.
Adjust the engine as per engine instruction manual.

- Once the engine adjustment have been completed, proceed to adjustment of the clutch shift timing.
(Using a 2mm allen wrench to adjustment the clutch cam.)

Note:

Clockwise-----Shift timing will become slower.
Counterclockwise---Shift timing will become quicker.

- Adjust the clutch shift timing for your track conditions with 4x4mm set screw. As you tighten (Clockwise) the 4x4mm set screw, the shift timing will become slower. As you loosen (Counterclockwise) the 4x4mm set screw, the shift timing will become quicker.
- Set the shift timing to the track conditions while the car is running.

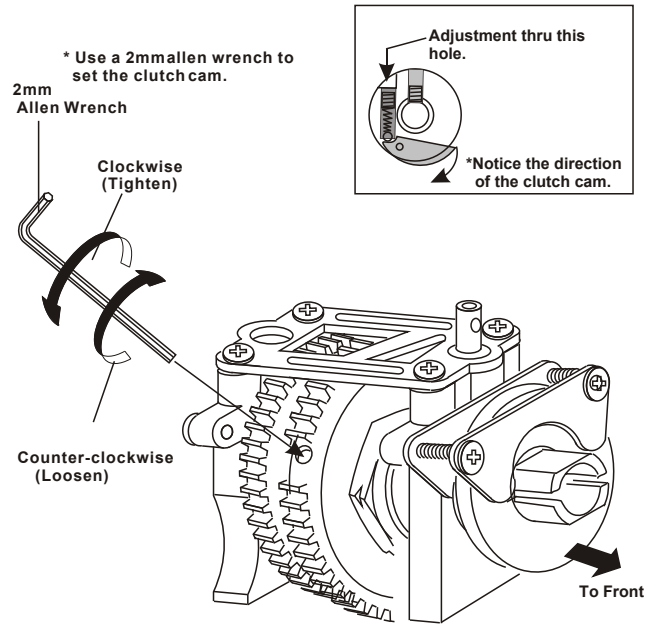

2 SPEED GEAR RATIO COMBINATIONS

The #35001 2-speed transmission allows the car to have more punch out of the corners and higher top speed. We offer many different pinion and spur gear combinations which can be used for different tracks.

IMPORTANT:

The sum of the spur gear and clutch gear for 1st gear must be equal the sum of the spur gear and clutch gear for 2nd gear be equal.

Example: 1st gear $45+13=58$
2nd gear $41+17=58$ Must be equal

(STANDARD)

SPUR GEAR	CLUTCH GEAR (4 tooth difference)			
	13T/17T	14T/18T	15T/19T	16T/20T
49T/45T				
48T/44T				
47T/43T				

Short Track
Torque
Long Track
Top Speed

2 SPEED OPTION PARTS

SPUR GEAR(1st):

USA Parts No.	Description	(STD)
No.35249	49T Spur Gear	
No.35248	48T Spur Gear	
No.35247	47T Spur Gear	

SPUR GEAR(2nd):

USA Parts No.	Description	(STD)
No.35246	46T Spur Gear	
No.35245	45T Spur Gear	
No.35244	44T Spur Gear	

CLUTCH GEAR:

USA Parts No.	Description	(STD)
No.35220	13T/17T Gear	
No.35232	14T/18T Gear	
No.35233	15T/19T Gear	

CLUTCH GEAR (1st):

USA Parts No.	Description	(STD)
35238	14T Gear	
35239	15T Gear	
35240	16T Gear	
35241	17T Gear	

CLUTCH GEAR (2nd):

USA Parts No.	Description	(STD)
35252	17T Gear	
35253	18T Gear	
35254	19T Gear	
35255	20T Gear	
35256	21T Gear	

2 SPEED SPARE PARTS

USA Parts No.	Description
35225	1st Spur Gear Holder
35228	Alum. Nut (Counter-Clockwise)
35230	8x12mm Flange Ball bearing
35222	Center Shaft
34110	5x10x4mm Ball bearing
35242	Clutch Bell Base
35249	49T Spur Gear (1st)
35245	45T Spur Gear (2nd)
35226	2nd Spur Gear Holder
35227	Clutch Cam Set
35229	18mm E-Ring
Misc Parts	Spring
	4mm Ball
	6x6mm Set Screw
35237	3x15mm Hex Screw
35231	8x10x1.5mm Alum. Ring
35243	Dust Cover, Steel